

# 31963-015

WATERPROOF CONNECTORS

## Filled Connectors for Low Voltage Use

### INSTALLATION INSTRUCTIONS

**IMPORTANT:** Turn off power before installing or removing connector.  
Product to be used in accordance with local and national codes.

1. Strip wires 3/8"(9.5mm)except #16 and smaller. Strip wires 7/16"(11.1mm).
2. Align frayed strands or conductors.
3. No pre-twisting needed. Hold stripped wires together with ends even. Note: Twist and lead stranded wires slightly.
4. Push wires firmly into connector when starting.
5. Twist connector onto wires pushing firmly until tight. Do not over torque, Do not reuse.

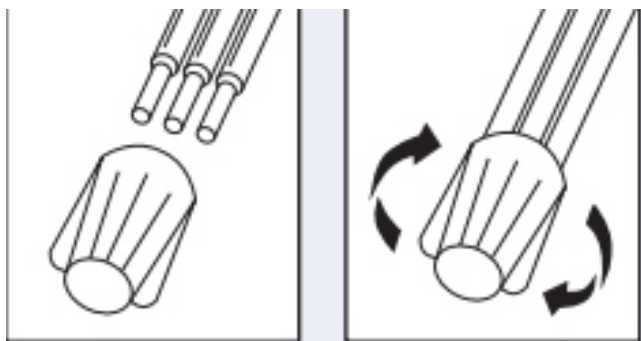

### PRODUCT SPECIFICATIONS & MEASUREMENTS

Max. Voltage: 30V/10AMP

Connector Size: 1/2"x1"

Wire Type: Copper/Copper

Wire Range: Min#22/Max#14

Temperature Rating: 105° C (221° F)

Petroleum Sealant Temperature: -45° F to 400° F

Measurements (Inches):

A-0.989 B-0.256  
C-0.494 D-0.374

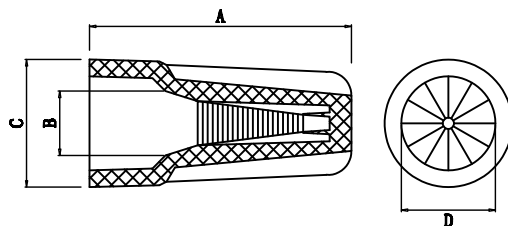

*Suitable for all underground low voltage applications.*

Note: Please refer to below wire Combinations.

|                    |                        |                          |
|--------------------|------------------------|--------------------------|
| 2 #14              | 1 #14 W/1-3 #18 or #20 | 3 #16 W/1 #18,#20 or #20 |
| 2-5 #18            | 2 #14 W/1 #18          | 1 #18 W/1-4 #20          |
| 3-5 #20            | 1 #16 W/1 #18          | 4 #18 W/1 #20            |
| 1 #14 W/1 or 2 #16 | 2 #16 W/1-2 #18 or #20 | 4 #20 W/1 #22            |